

Hoses and Hose Nipples

for Watercooled Sensors, Switching Adapter

Types 1203B..., 1221,
1225A..., 1227,
1231B..., 1231C...

Type	Lengths	Description	Application
1203Bsp	sp (L in m)	Polyethylene hose, 0 ... 6 bar, Ø4 mm	for Types 1221, 1225A... operating temperature ≤ 70 °C

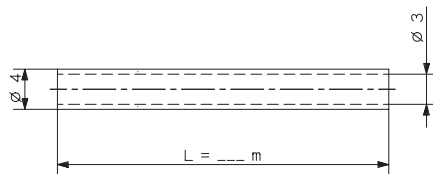

1203Csp	sp (L in m)	Viton hose, 0 ... 6 bar, Ø4 mm	for Types 1221, 1225A... operating temperature ≤ 200 °C
---------	-------------	--------------------------------	--

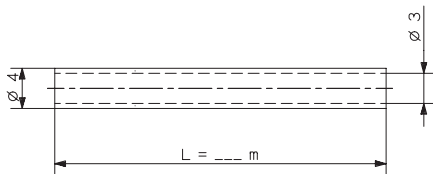

1221	L = 42 mm	Connecting tube for switching adapters (max. 20 bar), incl. O-Ring Type 1167	for Types 6521, 737, 741A, 7507
------	-----------	---	---------------------------------

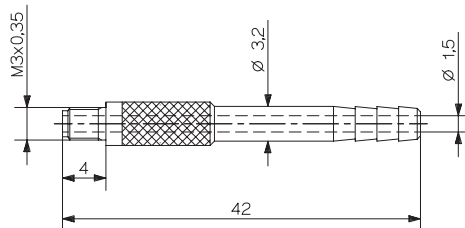

000-095e-06.03 (DB05.011e)

Type	Lengths	Description	Application
1225A1	L = 43 mm	Connecting tube (max. 20 bar)	for Types 6041..., 6043..., 6061..., 7061..., 7063..., 7531...
1225A2	L = 33 mm	Connecting tube (max. 20 bar)	for Types 6067..., 7063...
1225A3	L = 27,5 mm		option
1225A4	L = 24 mm	Connecting tube (max. 20 bar)	option
1225Q...	Special versions upon request		

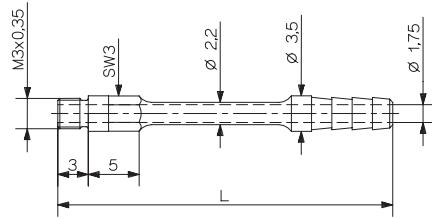

1227	L = 40 mm	Hose nipple for Type 7261 (1/8" G)	for Type 7261
------	-----------	------------------------------------	---------------

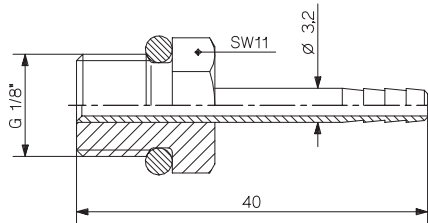

1231B...	1,5/sp (L in m)	Control-air hose for switching adapters, 0 ... 150 bar	for Type 7531 to conical nipple 60 ° R1/8"
----------	-----------------	--	--

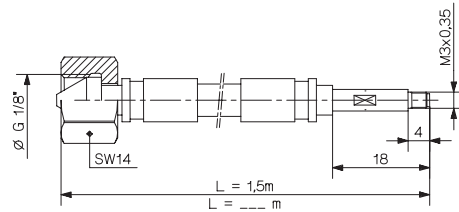

1231C...	0,4/sp (L in m)	Control-air hose for switching adapters, 0 ... 150 bar	for Type 7531 to pneumatic coupling
----------	-----------------	--	-------------------------------------

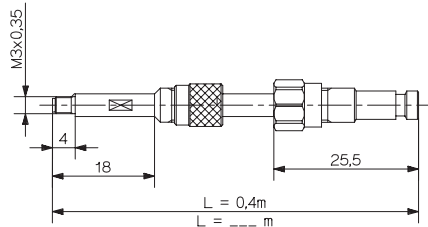

000-095e-06.03 (DB05.011e)